



Le Reve Cache

La Route De Maufant
St. Saviour
JE2 7HX

£2,600,000

FC308

FREEHOLD - This stunning Georgian 5 bedroom, 3 bathroom home in St. Saviour offers a perfect blend of comfort, style, and practicality. Upon entering, you are greeted by a vast and airy hallway that sets the tone for the rest of the home. The heart of the property is the open-plan kitchen, featuring a charming exposed brick wall that adds character and warmth to the space. The kitchen flows seamlessly into the TV lounge, providing a relaxed environment for family and friends. A quiet library, painted in soft neutral tones, adds a peaceful spot for reading or reflection.

On the ground floor, there is a convenient downstairs WC and a spacious bedroom with an ensuite bathroom, offering privacy and comfort. Moving upstairs, you'll find three generous bedrooms along with a family bathroom. The top floor is dedicated to the master bedroom, which includes its own ensuite bathroom, providing a luxurious retreat.

The outdoor space is just as impressive, with a large, sunny south-facing garden perfect for outdoor activities and relaxation. A newly built gym and a separate home office provide the flexibility to work out or work from home in comfort and privacy.

Securely accessed via a private gated entrance, this home offers both peace of mind and a sense of exclusivity. Its prime location ensures easy access to the town centre and is within close proximity to all leading private schools, including St Michael's Preparatory School, Victoria College, Jersey College for Girls, Beaulieu, De La Salle, and FCJ making it particularly attractive for families.













Ground Floor Building 1

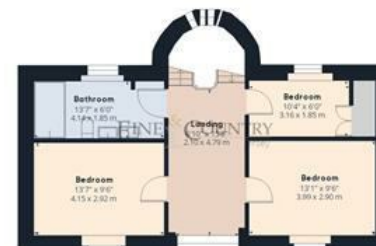

Floor 1 Building 1



Floor 2 Building 1



Ground Floor Building 2

Approximate total area⁽¹⁾

2685.19 ft²

249.46 m²

Reduced headroom

115.16 ft²

10.7 m²

(1) Excluding balconies and terraces

Reduced headroom

..... Below 5 ft/1.5 m

While every attempt has been made to ensure accuracy, all measurements are approximate, not to scale. This floor plan is for illustrative purposes only.

Calculations are based on RICS IPMS 3C standard.

GIRAFFE360

Outside

Large south facing garden offering complete privacy
Gated entrance
Separate building with a gym & home office

Services

All mains
Oil heating
Aga electric
Underfloor heating in kitchen
Working fire
Heating in office is electric

Directions

On La Route de Maufant head towards the zoo, pass the greenhouses and fields on the left, Le Reve Cache is the 2nd house on left after the fields, the gates will open automatically.

Call us on

01534 888855

jersey@fineandcountry.com

www.fineandcountry.je

5 King Street, St Helier, Jersey, JE2 4WF

MONEY LAUNDERING REGULATION - Once an offer is accepted and negotiations for the purchase of a property are entered into, the prospective purchasers will be asked to produce photographic identification and proof of residency documentation, e.g. current utility bill and ID. This is in order for us to comply with the current Money Laundering Legislation.

Fine & Country Jersey advises prospective purchasers that we have prepared these sales particulars as a general guide only. We have not carried out a detailed survey, nor tested the services, appliances and specified fittings. Room sizes are approximate and rounded; they are taken between internal wall surfaces and therefore include cupboards/shelves etc, accordingly they should not be relied upon when purchasing fittings. Carpet, curtains/blinds and kitchen equipment, whether fitted or not, are deemed to be removable by the vendor unless specifically itemised within these particulars and/or within the property inventory. These particulars are supplied on the understanding that all negotiations are conducted through Fine & Country Jersey, their accuracy is not guaranteed nor do they form part of any contract.